

GCHOTTKY BARRIER RECTIFIERS

Features

- ◆ High current capability
- ◆ Low forward voltage drop
- ◆ Low power loss, high efficiency
- ◆ High surge capability
- ◆ High temperature soldering guaranteed
- ◆ Mounting position: any

Mechanical Data

- Case : JEDEC TO-220AB Molded plastic body
- Weight : 0.067ounce, 1.9 grams
- Terminals: Lead solderable per MIL-STD-202, Method 208

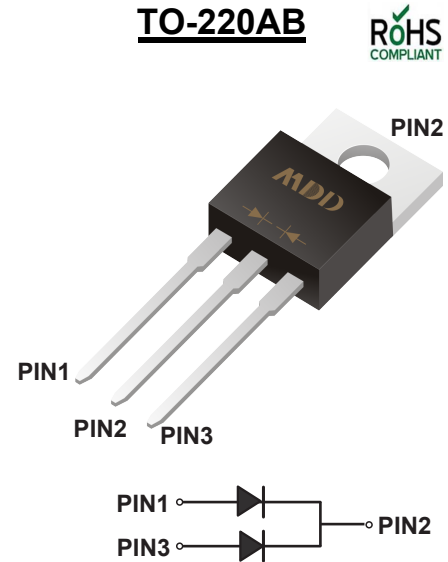

Maximum Ratings And Electrical Characteristics

Ratings at 25°C ambient temperature unless otherwise specified

MCHARACTERISTICS	SYMBOL	MBR20U100DCT	UNITS
Maximum repetitive peak reverse voltage	V_{RRM}	100	V
Maximum RMS voltage	V_{RMS}	70	V
Maximum DC blocking voltage	V_{DC}	100	V
Maximum average forward rectified current per leg per device	$I_{(AV)}$	10 20	A
Peak forward surge current 8.3ms single half sine-wave superimposed on rated load (JEDEC Method) per leg	I_{FSM}	200	A
Maximum instantaneous forward voltage at 10A(per leg)	V_F	0.72	V
Maximum DC reverse current $T_A=25^\circ\text{C}$ at rated DC blocking voltage $T_A=125^\circ\text{C}$	I_R	0.1 20	mA
Typical Junction Capacitance(note1)	C_J	600	pF
Maximum Thermal Resistance Junction To Case	$R_{\theta JC}$	2	$^\circ\text{C/W}$
Operating junction and storage temperature range	T_J, T_{STG}	-55 to +150	$^\circ\text{C}$

Note: 1. Measured at 1 MHz and applied reverse voltage of 4 V D.C

Ratings And Characteristic Curves

Fig.1 Typical Forward Current Derating Curve

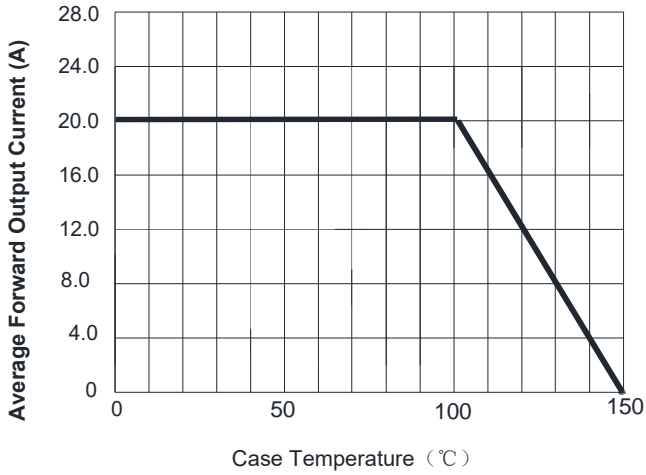

Fig.2 Maximum Non-Repetitive Peak Forward Surge Current

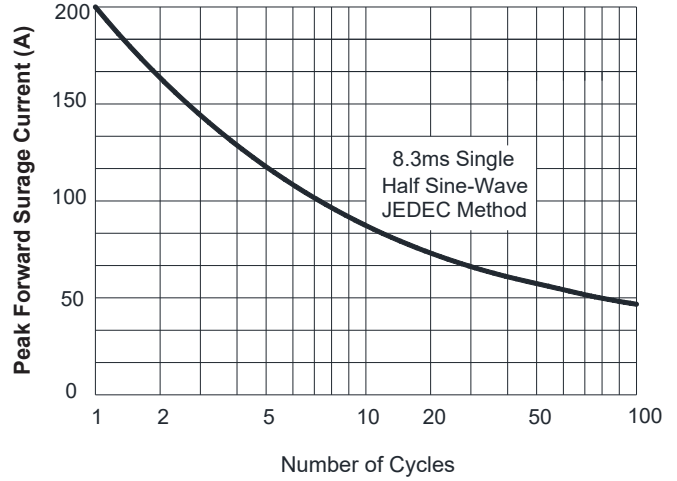

Fig.3 Typical Forward Characteristic(per leg)

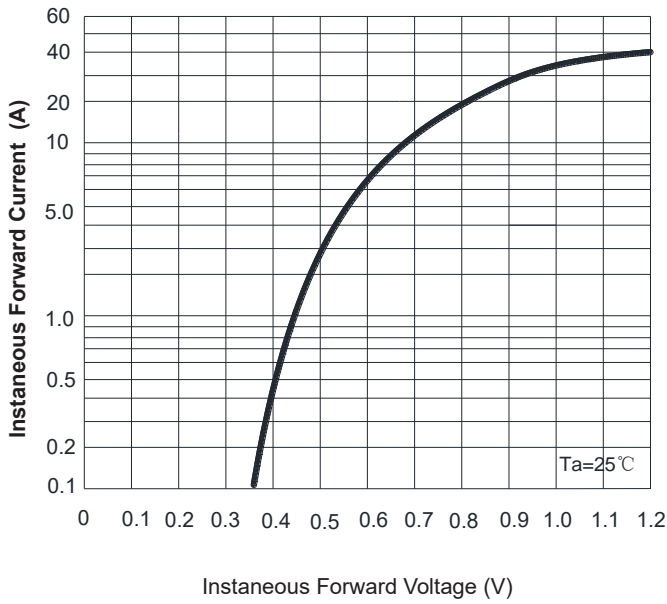
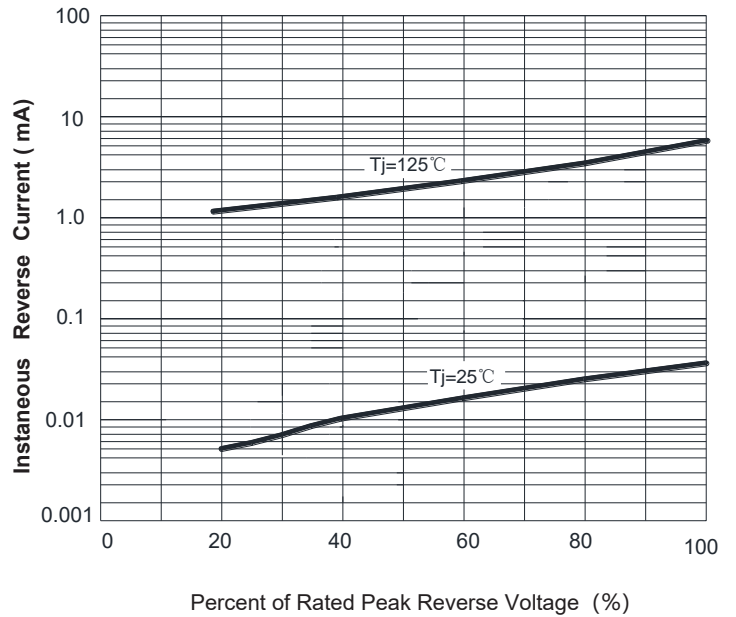

Fig.2 Typical Reverse Characteristics



The curve above is for reference only.

Outline

TO-220AB Package Outline Dimensions

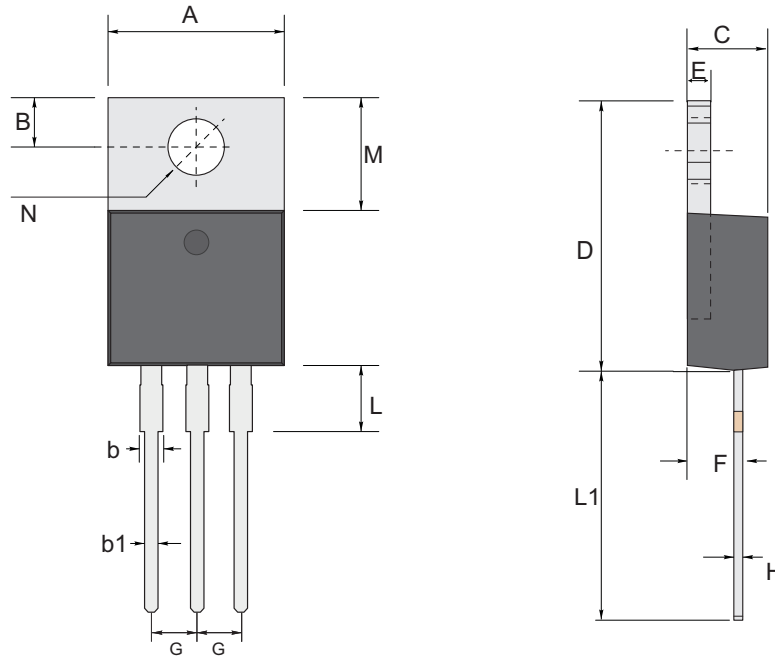

TO-220AB mechanical data

UNIT		A	B	b	b1	C	D	E	F	G	H	L	L1	M	N
mm	max	10.45	2.94	1.77	0.94	4.76	16.0	1.40	2.90	2.54 TYPICAL	0.64	4.2	14.79	6.60	3.86
	min	9.85	2.54	1.14	0.62	4.42	14.6	1.14	2.20		0.35	2.8	13.00	6.13	3.8

Important Notice and Disclaimer

Microdiode Electronics (Shenzhen) reserves the right to make changes to this document and its products and specifications at any time without notice. Customers should obtain and confirm the latest product information and specifications before final design, purchase or use.

Microdiode Electronics (Shenzhen) makes no warranty, representation or guarantee regarding the suitability of its products for any particular purpose, nor does Microdiode Electronics (Shenzhen) assume any liability for application assistance or customer product design. Microdiode Electronics (Shenzhen) does not warrant or accept any liability with products which are purchased or used for any unintended or unauthorized application.

No license is granted by implication or otherwise under any intellectual property rights of Microdiode Electronics (Shenzhen).

Microdiode Electronics (Shenzhen) products are not authorized for use as critical components in life support devices or systems without express written approval of Microdiode Electronics (Shenzhen).